

South Carolina
 Pursuant to a warrant from John Thomas, Com^r of locations dated 3rd Oct^r 1794, I have admeasured and laid out unto **Atthey Neeks** a tract of two hundred and seventy five acres of land in Greenville County on the branches of Mount Pleasant Creek waters of Saluda River Bound^{ry} line running N. 75° E. on lands laid out for Atthey Neeks, by lines running N. 75° E. on such shape, form and marks as the above plat represents, Recorded 1st Oct^r 1798. **Benjⁿ Arnold D^s**
 Survey^d 29th Oct^r 1791 - **John Mays** Elapsed this 1st Oct^r 1798

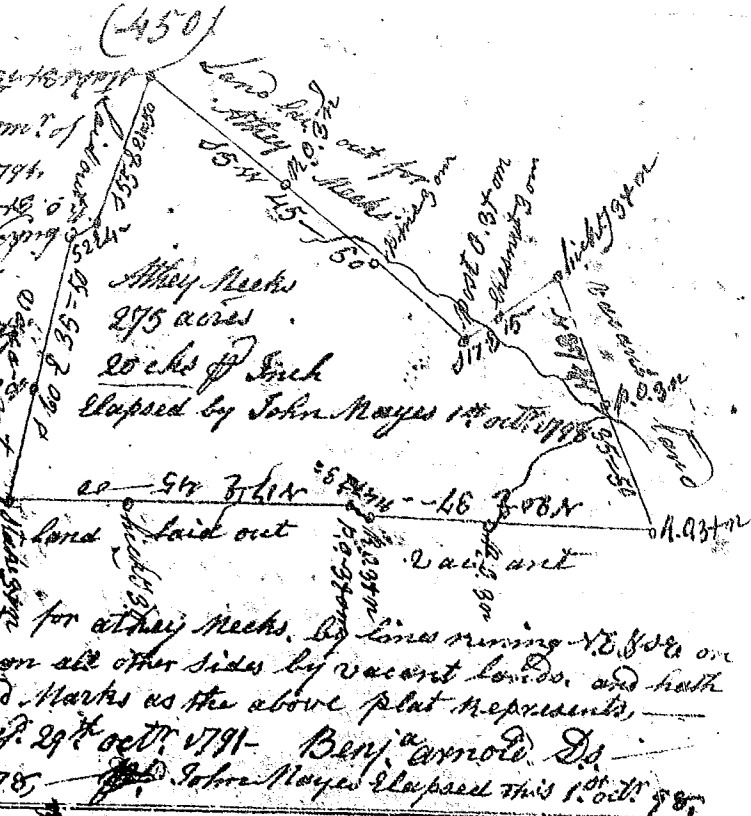

South Carolina Pursuant to a warrant from John Thomas, Com^r of loc^s dated 8th Sept^r 1798, I have measured & laid out unto **Nathaniel Walker** a tract of four hundred and eighty acres of land on both sides of **Wards Creek**, and a small branch of **Fork Creek** waters of a fork of **Sage-er river**, in Spartan-**burg County**, bounded by lines running S 55 E by **Burns E. unknown** N. E. & S. E. by an old survey called **Playwoods land** S. by **William Frances** land N. W. by **William D. Thomas** S. 22 E. by the ancient boundary line, and hath such form & marks as the above plat represents, Certified the 15th 1798 - Recorded 2nd Oct^r 1798 - **Wm D. Thomas D^s**

